

MarVision SM 150 / SM 151

Stereo Zoom Microscope

FEATURES

- High quality optics for light intensive and sharp 3D images
- Variable magnification due to adjustable zoom lens
- Focusing with an ergonomic handwheel, mounted either side, ideal for either a left or right handed operator
- Prism head tilted to 45° and rotatable through 360°; with dioptic adjustment
- Integrated incident and transmitted illumination, continuously variable
- Optional digital camera mounting is possible (SM 151)
- **Package contains:** Eyepiece 10x with eyecup, dust cover, glass and plastic plate black/white, instruction manual

Application:

- For the visual inspection of work-pieces on the production line and in quality assurance



TECHNICAL DATA

Order no.	4245001	4245002	4245061	4245062
Product type	SM 150	SM 151	SM 150	SM 151
Observation tube angle	45°			
Camera connector	no	yes	no	yes
Optical tube	Binocular	Trinocular	Binocular	Trinocular
Field of vision - diameter	mm 28 -5			
Magnification	variable 7x-45x			
Working distance	mm 105			
Max. object height	mm 75			
Illumination	12 V / 15 W, Incident and transmitted light, variable			
Energy supply	230 V / 50 Hz		110 V / 60 Hz	

Order no.	Contact surface
4245001	260 x 200 mm
4245002	260 x 200 mm
4245061	260 x 200 mm
4245062	260 x 200 mm

ACCESSORIES

Order no.	Product name	Product type
4245030	LED ring light	150 lr
4245067	Cold light source	300 fs
4245042	Fiber optic gooseneck, 2 arms, L = 500 mm, D = 40 mm	200 fl
4245010	Eyepiece lens 15x	150 e15
4245011	Eyepiece lens 20x	150 e20
4245012	Eyepiece lens 10x with glass reticle (1x)	150 e10s
4245021	Ancillary lens 2x	150 v2.0
4245020	Ancillary lens 0.5x	150 v0.5
4245026	Digital camera with adapter	150 cam

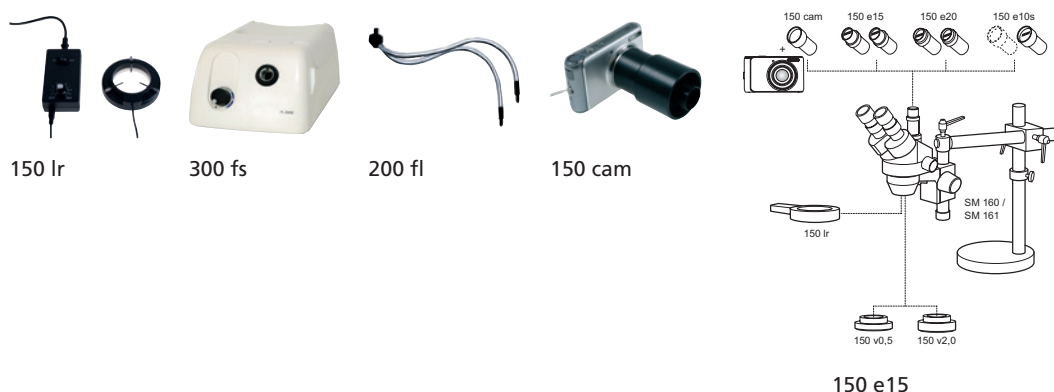

MarVision SM 160 / SM 161

Stereo Zoom Microscope

FEATURES

- High quality optics for light intensive and sharp 3D images
- Variable magnification due to adjustable zoom lens
- Focusing with an ergonomic handwheel, mounted either side, ideal for either a left or right handed operator
- Prism head tilted to 45° and rotatable through 360°; with the dioptic adjustment
- Optional digital camera mounting is possible (SM 161)
- **Package contains:** Eyepiece 10x with eyecup, dust cover, instruction manual

Application:

- For the visual inspection of workpieces on the production line and in quality assurance



TECHNICAL DATA

Order no.	4245003	4245004	4245063	4245064
Product type	SM 160	SM 161	SM 160	SM 161
Observation tube angle	45°			
Camera connector	No	Yes	No	Yes
Optical tube	Binocular	Trinocular	Binocular	Trinocular
Field of vision - diameter	mm	28 – 5		
Magnification	Variable 7x–45x			
Working distance	mm	105		
Energy supply	230 V / 50 Hz		110 V / 60 Hz	

Order no.	Contact surface
4245003	230 x 230 mm
4245004	230 x 230 mm
4245063	230 x 230 mm
4245064	230 x 230 mm

ACCESSORIES

Order no.	Product name	Product type
4245030	LED ring light	150 lr
4245067	Cold light source	300 fs
4245042	Fiber optic gooseneck, 2 arms, L = 500 mm, D = 40 mm	200 fl
4245010	Eyepiece lens 15x	150 e15
4245011	Eyepiece lens 20x	150 e20
4245012	Eyepiece lens 10x with glass reticle (1x)	150 e10s
4245021	Ancillary lens 2x	150 v2.0
4245020	Ancillary lens 0.5x	150 v0.5
4245026	Digital camera with adapter	150 cam



150 lr



300 fs



200 fl



150 cam

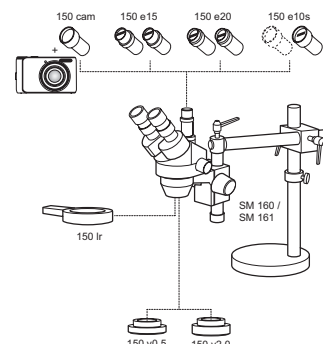

150 e15